

Transmitter Key and Code Setting

Refer to pcb Index on Page 17

Key Setting

Choose the Transmitter key configuration
(Key 1. Key 2. Key 3) from the following:

Single door installation (A)

Key 1

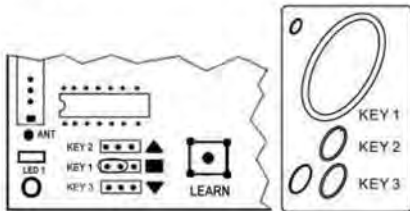

The above jumper configuration will allow Key 1 on the hand transmitter to be programmed.

Note: The jumpers are located on the Powerhead Printed Circuit Board. (Key 1. Key 2. Key 3)

Single door Installation (B)

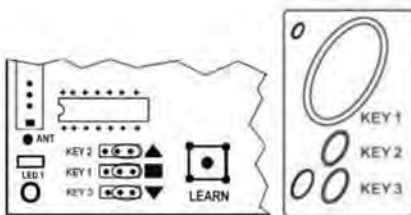

This above configuration uses all three keys

- ▲ Up Key 2
- Stop Key 1
- ▼ Down Key 3

Two or Three door installation

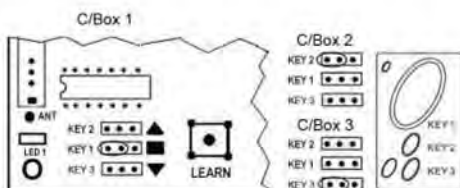

Two or Three door installation

Door 1

Jumper configuration for transmitter Key 1 only

Door 2

Jumper configuration for transmitter Key 2 only

Door 3

Jumper configuration for transmitter Key 3 only

Code Setting

Once the Key configuration is set you can now program in the security code from your hand transmitter (s)

- Press the learn code key once
- Learn LED indicator will light
- Press the hand transmitter Key 1 that will operate the door eg: for single door installation (A) you would press Key 1
- Learn LED will go out
- The hand transmitter is now programmed

Multiple Hand Transmitters

Repeat the above instructions for any subsequent Hand Transmitters.

The Control Module has enough memory for up to 15 individual Hand Transmitters.

If more than 15 handsets are learnt the FIFO (First In First Out) system applies ie first Hand transmitter code learnt will be deleted and replaced by the last Hand Transmitter code learnt.

Deleting Hand Transmitters From Memory

Press and hold the learn code key for 5 seconds.

All transmitter codes held in the memory have been erased.

Note: If a transmitter is lost or stolen please erase the memory and re-learn any spare or new transmitters.

Key Ring Transmitter

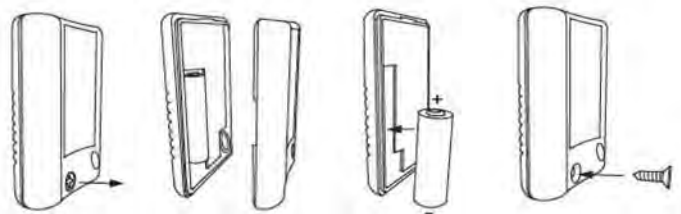

Battery Type 12V (A23)(ALKALINE BATTERY)

The battery should be replaced every 12 months.

To reassemble:

- Holding the front cover of the remote in one hand remove the screw on the back case using philip head screw driver.
- Replace the old battery with new 12 Volts (A23 Alkaline) Battery Negative towards the screw.
- Locate the Back case and secure with screw.